

KITCHEN
DINING
RT

WALL UNIT
THAT FORMALLY
MECHANICALLY
OPERATES

OPENING
EXPOSE
SUPPORT
PROVIDER

LOW LEVEL
HORIZONTAL
OPENING
UNIT

WET AREA
NON-SLIP

CORNER
VENTILATION
ABOVE

open plan

SEATING
AREAS
BASE OF
ACCESS

Open plan II

DEFINABLE
SPACE

SOOTH

OPENING

DOUBLE
BEAM
OPENING
CANTILEVER

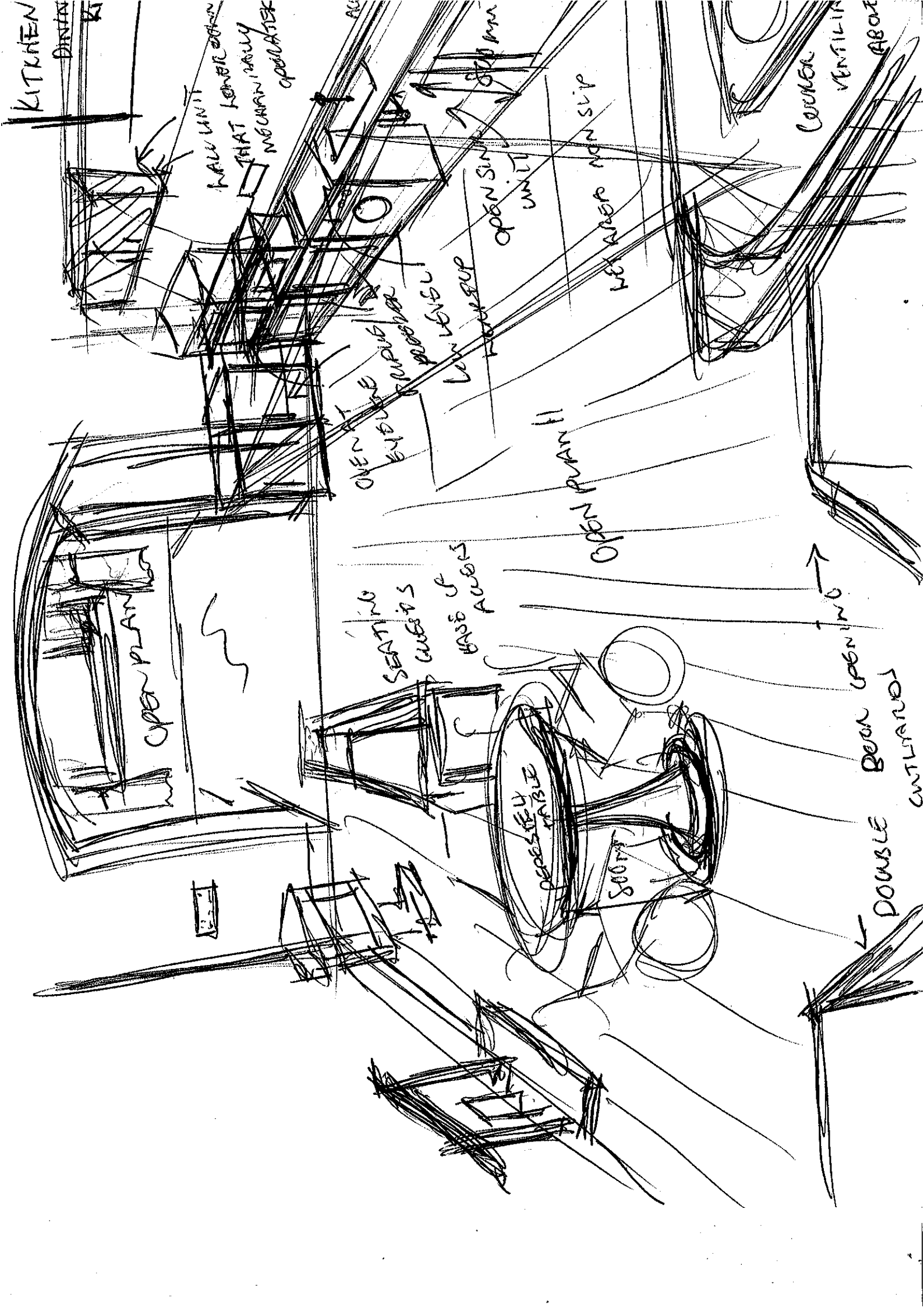

DINNING AREA

- CIRCULAR TABLE FOR BASE OF USE
- 700-800 TABLE HEIGHT
- TABLE SUSPENDED ON PEDISTAL TO ALLOW WHEELCHAIRS
- NO SLIP FROM SURFACE
- LIGHT SWITCHES 900-1200 ABOVE & SOCKET
- SOCKETS WITH ON/OFF SWITCHES
- LOW WINDOW LULU HEIGHT FOR ACCESS
- WINDOW LATH; VIEW + VENTILATION

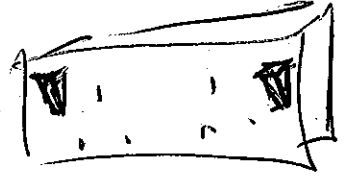

KITCHEN

- SINK LOWER FROM TRIANGULAR CLOSELY GROUPED
- SPACE EITHER SIDE OF WORKER HEIGHT
- NO WALL UNITS OVER SINK
- NO UNITS UNDER SINK
- EXTRACTOR FAN + COOKER MAIN EASILY ACCESSIBLE
- LEVER TYPE TAPS ON SINK (MIXER TAP)
- APPLIANCES TO HAVE WORKTOP FACE ONE SIDE
- ~~OVER~~ WALL UNITS PRESS CAN BE MODIFIED TO PROP TO LEVEL THAT CAN BE ACCESSIBLE.